



Before You Start:

- Make sure you have a router and high-speed Internet access (not included).
- Connect your NVR to your router using an Ethernet cable (see the Quick Connection Guide for details).
- Upgrade your NVR firmware and client software or mobile app to the latest versions.
- Please note that an upload speed of 1Mbps is required for remote video streaming. Up to 3 devices may connect to the system at the same time.

1A iPhone

a Install the free **FLIR Cloud™** app from the App Store. Tap the **FLIR Cloud™** icon to open the app.



b Tap **Sign up** and enter your email address and password to create a new account.

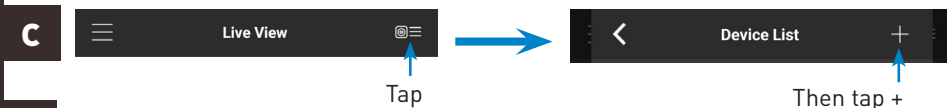

d Configure the following:

1 Tap **Scan QR Code** and line up the QR code on the top of the NVR using the camera on your iPhone.



OR under **Device ID**, manually enter the Device ID printed on the label.

- Name:** Choose a name for your system of your choice.
- Client Port:** Enter the **Client Port** (default: **35000**).
- Username:** Enter the **NVR's User Name** (default: **admin**).
- Password:** Enter the **NVR's Password** (default: **000000**).

EXAMPLE

e Tap **Connect**. You will be prompted to change the NVR password.

f Enter a new 6 character password and tap **OK**. This password will be used to log on to your system from now on.

g The app opens in Live View and streams video from all connected cameras.

1B iPad

a Install the free **FLIR Cloud™** app from the App Store. Tap the **FLIR Cloud™** icon to open the app.

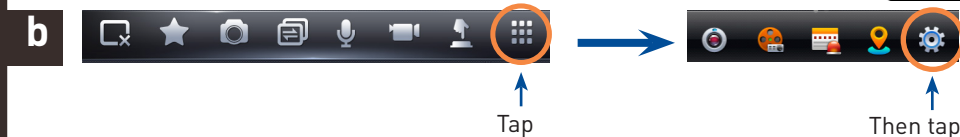
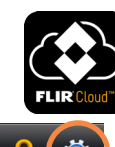

c Tap **Add**.

d Configure the following:

1 Tap **Start Scanning** and line up the QR code on the top of the NVR using the camera on your iPad.

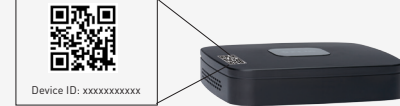

OR under **Device ID**, manually enter the Device ID printed on the label.

- Name:** Choose a name for your NVR of your choice.
- Client Port:** Enter the **Client Port** (default: **35000**).
- User Name:** Enter the **NVR's User Name** (default: **admin**).
- Password:** Enter the **NVR's Password** (default: **000000**).
- Channel amount:** Enter the number of channels your NVR has (for example 4, 8, or 16).

EXAMPLE

e Tap **Start Live View**. You will be prompted to change the NVR password.

f Enter a new 6 character password and tap **OK**. This password will be used to log on to your system from now on.

g The app opens in Live View and streams video from all connected cameras.

1C Android

a Install the free **FLIR Cloud™** app from the Google Play Store. Tap the **FLIR Cloud™** icon to open the app.



b Tap **Sign up** and enter your email address and password to create a new account.

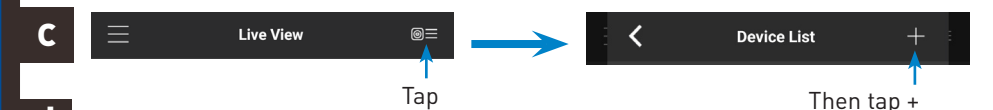

d Configure the following:

1 Tap **Scan QR Code** and line up the QR code on the top of the NVR using the camera on your phone or tablet.

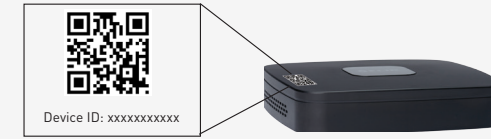

OR under **Device ID**, manually enter the Device ID printed on the label.

- Name:** Choose a name for your system of your choice.
- Client Port:** Enter the **Client Port** (default: **35000**).
- Username:** Enter the **NVR's User Name** (default: **admin**).
- Password:** Enter the **NVR's Password** (default: **000000**).

EXAMPLE

e Tap **Connect**. You will be prompted to change the NVR password.

f Enter a new 6 character password and tap **OK**. This password will be used to log on to your system from now on.

g The app opens in Live View and streams video from all connected cameras.



NOTE: PC/Mac setup is not required to connect on a smartphone or tablet. See reverse for smartphone/tablet setup.

2 Find your Device ID

The **Device ID** is printed on a label on the top panel of the NVR.

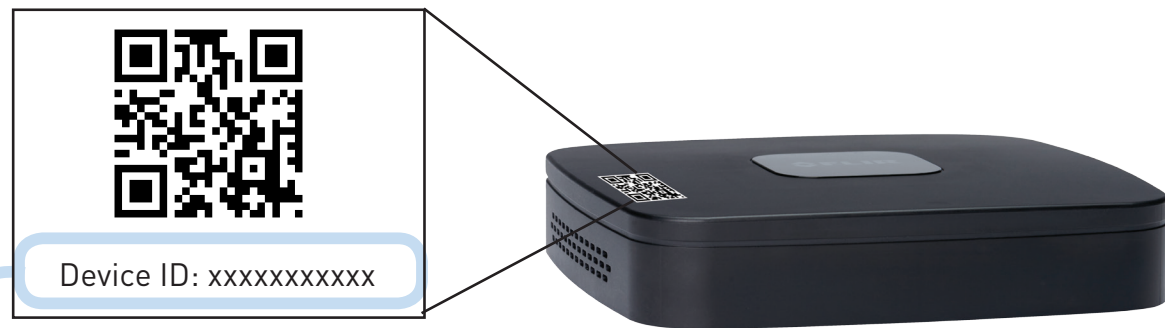

Record your information below:

DEVICE ID: _____

Quick Reference

Default access information:

- Default user name: **admin**
- Default password: **000000**

See the label on top of your NVR for your Device ID.

Default system ports:

- HTTP Port: **80**
- Client Port: **35000**

If you have forgotten your password, contact FLIR technical support.

Need Help?
Visit flir.com/security/support

FULL INSTRUCTION MANUAL ONLINE

Visit the address below to access the latest software and instruction manuals.



Visit flir.com/security/support

Information in this document is subject to change without notice. As our products are subject to continuous improvement, FLIR Systems, Inc. and our subsidiaries reserve the right to modify product design, specifications and prices, without notice and without incurring any obligation. E&OE © 2015 FLIR Systems, Inc. All rights reserved.

3 Connecting on PC or Mac

a Download and install the client software.

- **PC Users:** Download and install the **Client Software for PC** from flir.com/security/support.
- **Mac Users:** Download and install the **Client Software for Mac** from flir.com/security/support. Double click to extract the software. Then, drag the software to **Applications**.

b Once installation is finished, double-click the **FLIR Cloud Client™ icon** () on the desktop or Applications list.

c Log into the Client Software using the Client Software user name (default: **admin**) and password (default: **admin**) and then click **Login**.

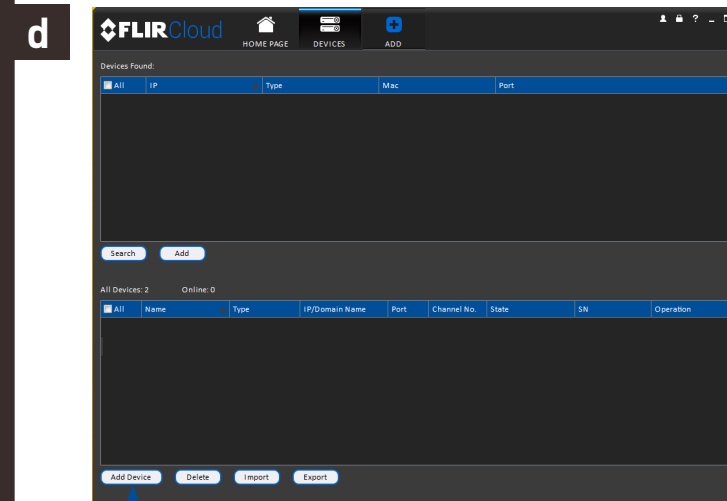
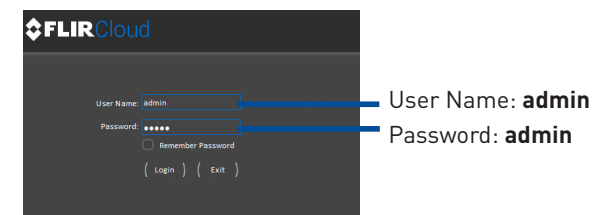

Click **Add Device**

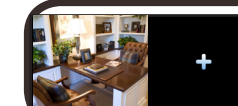

Congratulations! You can now connect over the Internet to view and playback video on your computer.

e Enter the following information:

- 1 Device Name:** Choose a name for your system of your choice.
- 2 Device ID:** Manually enter the **Device ID** printed on the label.
- 3 Client Port:** Enter the **Client Port** (default: **35000**).
- 4 User Name:** Enter the **NVR's User Name** (default: **admin**).
- 5 Password:** Enter the **NVR's Password** (default: **000000**).

EXAMPLE



Click **Add**

f You will be prompted to change the NVR password. Click **OK**.

g Enter a new 6 character password and tap **OK**. This password will be used to connect to your system from now on.

h Click then .

i Click and drag **Default Group** to the display window to open your cameras in live view.

