

PACKAGE CONTENTS:

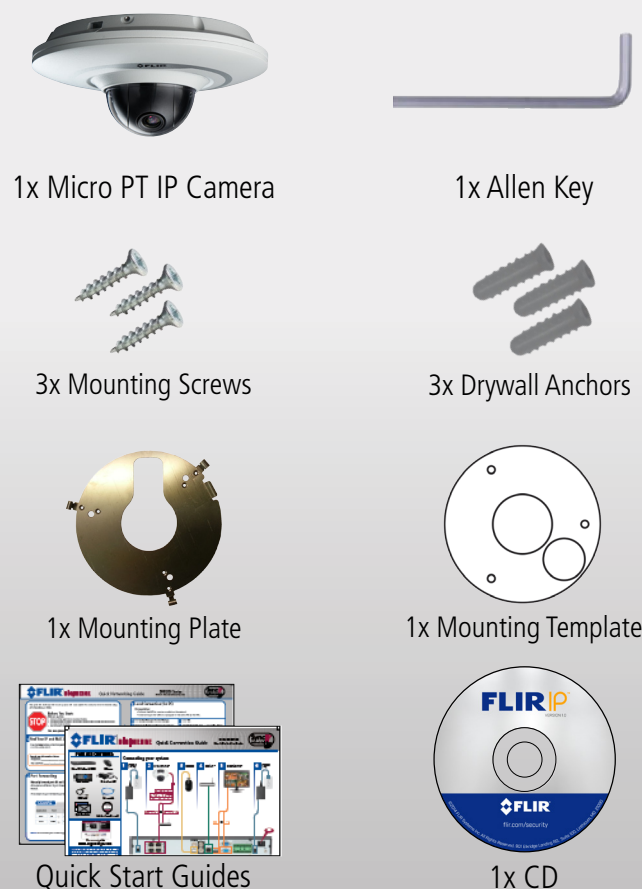

1 Installing the Camera

- A** Use the included mounting template to mark holes for the mounting screws and camera cable.
- B** Drill holes for the mounting screws and camera cable.
NOTE: Use the included drywall anchors if installing on a drywall surface.
- C** Align the metal mounting plate so that the 3 screw holes in the plate line up with the 3 holes drilled in the wall.
- D** Attach the flat side of the mounting plate to the surface using the included mounting screws (3x).

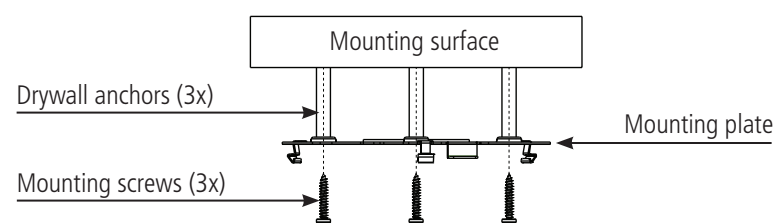

- E** Remove the M2x5 screw from the side of the camera using the included Allen key.

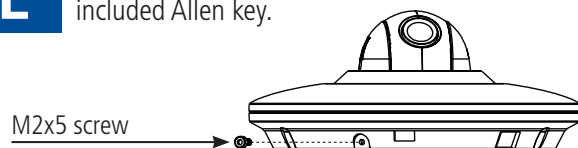

2 Installing the Camera (continued)

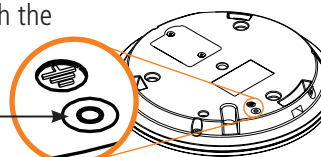
- F** Ensure the camera is grounded with the pre-inserted M2x5 screw.

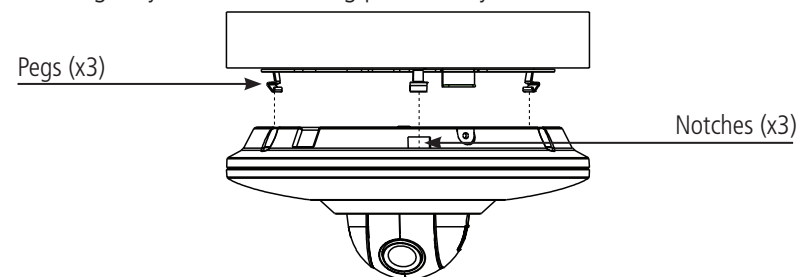
- G** Connect cables as shown in the section "Connecting the Camera".
- H** Align the 3 notches on the side of the dome camera with the 3 corresponding pegs on the mounting plate. Push the camera gently into the mounting plate until you hear a 'click'.



NOTE: The pegs and notches only align one way. Do not force the camera to fit into the mounting plate.

- I** Re-insert the M2x5 screw removed in Step E. Tighten firmly using the included Allen key.
- J** Remove the vinyl film from the camera lens once installation is complete.

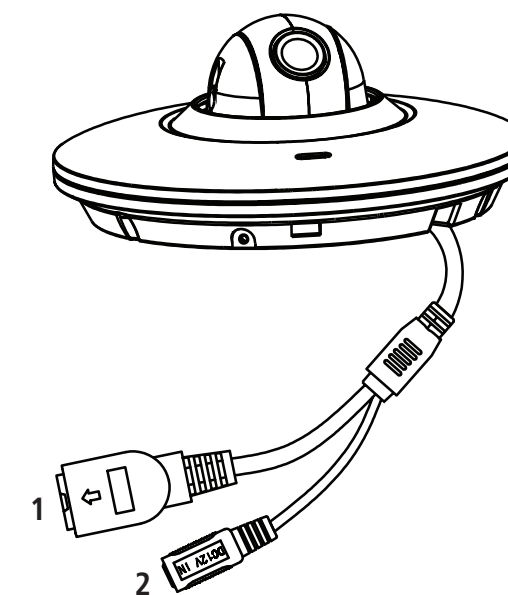
3 Connecting the Camera



- 1. Ethernet Port:** Connect the camera to an NVR or a router or switch on your network using Cat5e or better Ethernet cable (not included). PoE Class 3 supported.
- 2. Power Input:** If not using PoE, connect the camera to a 12V DC power source (300mA or higher required).

Latest software and manuals available on www.flirsecurity.com/pro



For support, visit www.flirsecurity.com/pro

Information in this document is subject to change without notice. As our products are subject to continuous improvement, FLIR Systems, Inc. and our subsidiaries reserve the right to modify product design, specifications and prices, without notice and without incurring any obligation. E&OE © 2014 FLIR Systems, Inc. All rights reserved.

Weights & Dimensions

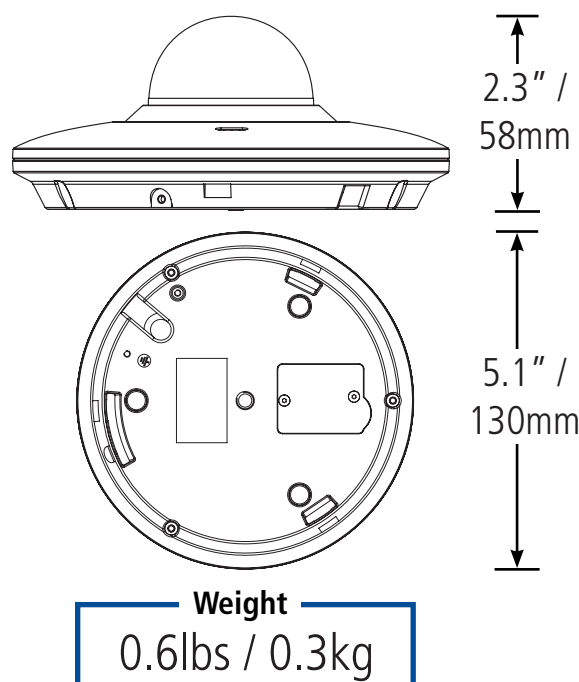

Inserting the microSD Card

- A** Separate the camera from the mounting plate if needed.
- B** Remove the 2 screws from the compartment cover using a Phillips screwdriver (not included).
- C** Slide the microSD carriage cover to open, then lift upward.
- D** Place a microSD card (not included) into the carriage with the metal contacts facing down.
- E** Close and lock the carriage cover. Replace the compartment cover on the camera base.

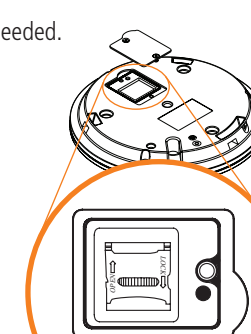

Resetting the Camera

- A** Separate the camera from the mounting plate if needed.
- B** Remove the 2 screws from the compartment cover using a Phillips screwdriver (not included).
- C** Press and hold the reset button for 4 seconds.
- D** Replace the compartment cover on the camera base.

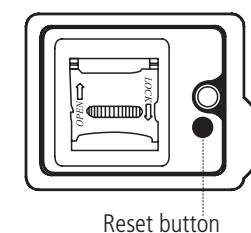

Safety Precautions

- Use an appropriate low voltage power cable to prevent fire or electrical shock.
- Make sure to install the camera in an area that can support the camera weight.
- There are no user serviceable parts inside the camera. Please do not disassemble the camera.
- Do not clean the lens cover with an abrasive cleaning material. Please use a lint free micro-fiber cloth to clean the lens cover.
- Camera is rated for outdoor use (IP66), but is not intended for submersion in water.

FCC Notice

This equipment has been tested and found to comply with the limits for a Class A digital device, pursuant to Part 15 of the FCC Rules. These limits are designed to provide reasonable protection against harmful interference when the equipment is operated in a commercial environment. This equipment generates, uses, and can radiate radio frequency energy and, if not installed and used in accordance with the instruction manual, may cause harmful interference to radio communications. Operation of this equipment in a residential area is likely to cause harmful interference in which case the user will be required to correct the interference at his own expense.